

TFD24 Ford Ranger & Volkswagen Amarok 2023>

Item	Qty	Description	Item	Qty	Description
A	1	TFD24 Crossbar	C	2	M16 x 60 Bolts & Nyloc Nuts
B1	1	Left Hand Side Arm	D	4	M8 x 30 Bolts & S/P Washers
B2	1	Right Hand Side Arm	E	2	M12 x 35 Bolts & S/P Washers
CS	1	Coupling Spacer	F	6	M14 x 45 Bolts & Nyloc Nuts
X	2	Original Location Pins	G	8	M14 x 140 Bolts & S/P Washers
			H	4	8 x 25 Flat Washers
			J	2	12 x 25 Flat Washers
			K	20	14 x 27 Flat Washers

Bumper Removal:

1. With reference to Fig 1, unplug the wiring loom shown in **PURPLE** then remove the three fixings from each side shown in **RED** then slide bumper off rearwards.
2. Remove the two fixings each side, shown in **CYAN** to remove the internal bumper beam from off the chassis ensuring the loom and its plastic retainers are unclipped from the arms. Once removed from the vehicle extract the location pins **X**. (The bumper beam and it's fixings are not refitted with the towbar assembly).

Towbar Installation:

1. Insert the location pins **X** into items **B1** and **B2**.
2. Loosely fix items **B1** and **B2** to the underside of the chassis using items **G** with items **K**.
3. Fix Item **A** to items **B1** and **B2** using items **F** with items **K**. (Note it may be necessary on some models to lower the spare wheel).
4. Fully tighten all fixings ensuring the Towbar is rigid, square and secure.

Bumper Attachment:

1. Loosely screw items **D** with items **H** into the innermost bumper fixing points then slide the bumper on the top of item **A**.
2. Using items **D** with items **H** and items **E** with items **J** insert the remaining bumper fixings.
3. Using item **C** bolt your chosen ball bracket and wiring plate (not supplied in this kit) to item **A** with item **CS** on the rear face of the flange plate and fully tighten all fixings ensuring the Towbar and bumper are rigid, square and secure.

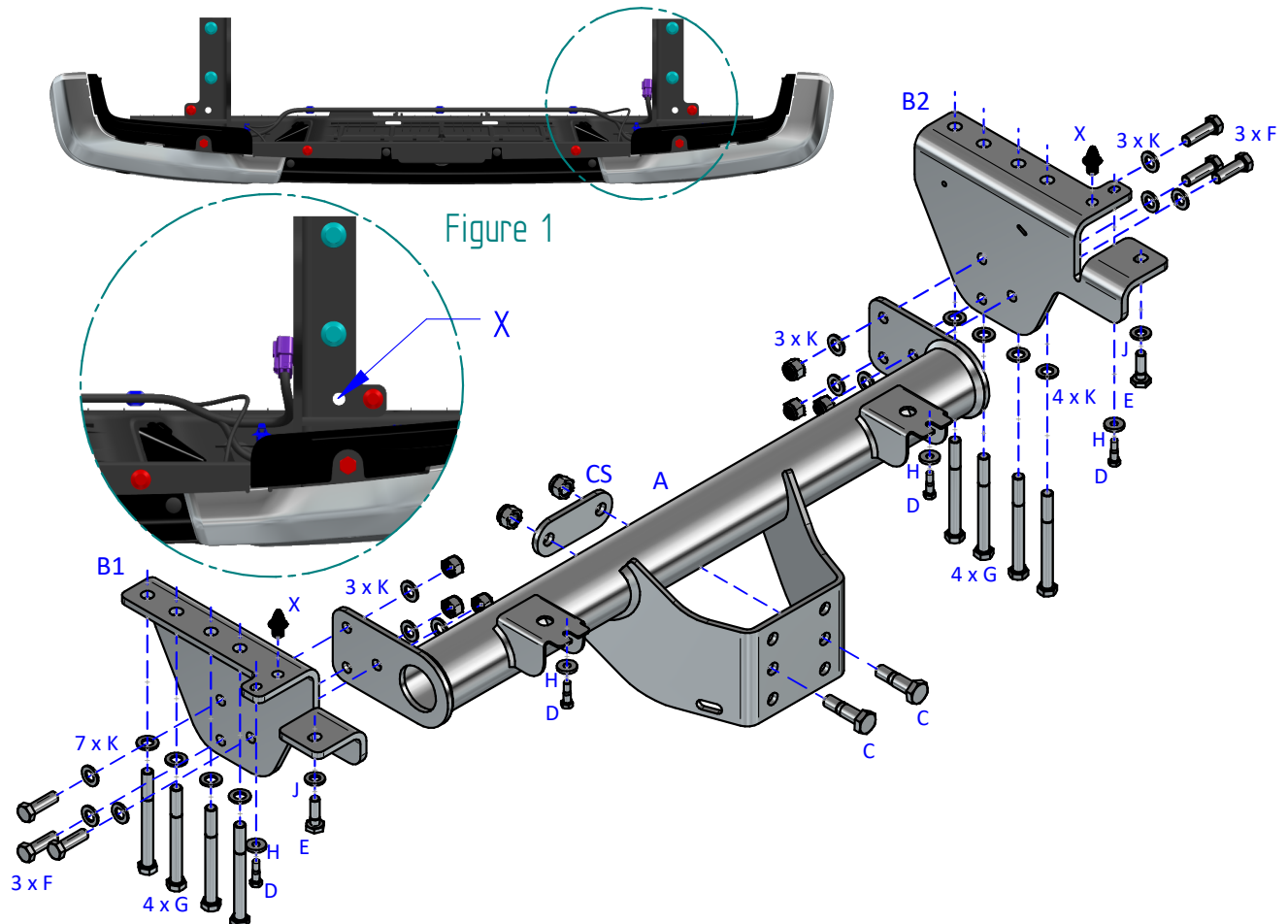

Notes:

1. For Torque settings see general notes overleaf.
2. Nose load limits and vehicle manufacturer's trailer / caravan weight limits must be observed.
3. We recommend the use of PRO-TOW Couplings with all our products.