

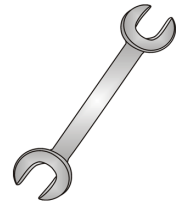

Tow-Trust Towbars

Important: Please read General Notes overleaf before fitting



Issue 3

TP428A PEUGEOT PARTNER VAN 1996 – 2008 COMBI VAN 2001> CITROEN BERLINGO VAN & MULTISPACE 1996 – 2008 BERLINGO FIRST 2008>

Item	Qty	Description	Item	Qty	Description
A	1	Towbar	E	2	M16 x 50 Bolts, Nuts & S/P Washers
B	2	Handed Side Arms	F	4	M10 x 90 Bolts, Nuts & S/P Washers
C	1	Extension Bar	G	2	M8 x 30 Bolts & S/P Washers
D	4	15 x 52 Spacer Bushes	H	4	M10 x 35 Bolts, Nuts & S/P Washers
			J	2	M12 x 85 Grade 10.9 Bolts & Nyloc Nuts
			K	4	10 x 40 Flat Washers
			L	4	12 x 25 Flat Washers
			M	8	10 x 25 Flat Washers
			N	2	8 x 25 H/D Flat Washers

1. Remove the spare wheel.
2. Cut a small section centrally from the lower edge of the bumper 60mm wide and up to the two existing holes.
3. Locate Item **A** between the rear panel and the lower edge of the bumper with the two tabs on the rear face of the rear panel.
4. Using Item **G** with Item **N** loosely bolt Item **A** to the rear panel through the two existing holes.
5. Locate the existing mounting points in the side face of each chassis member and using Item **F** with Item **K**, Item **M** and Item **D** loosely bolt Item **B** to the inside face of each chassis member.
6. Using Item **H** with Item **M** bolt Item **B** to Item **A**.
7. Using Item **J** with Item **L** bolt Item **C** to Item **A**.
8. Using Item **E** bolt the ball bracket and wiring plate (not supplied in this kit) to the mounting plate.
9. Fully tighten all nuts and bolts and ensure the towbar is rigid and secure.
10. Replace the spare wheel.

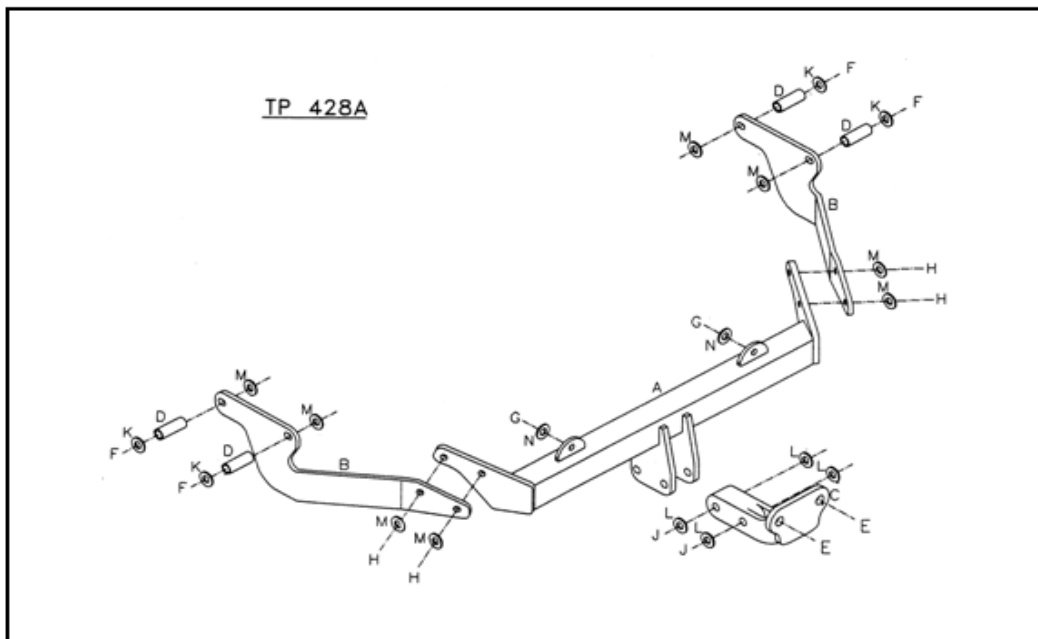

Note:

1. Recommended Torque Setting for M12 Grade 10.9 -139 Nm. (For other Torque Settings see notes overleaf.)
2. Nose load limits and vehicle manufacturers trailer / caravan weight limits must be observed.