

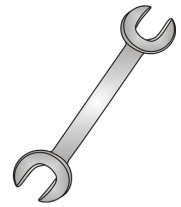

Tow-Trust Towbars

Important: Please read General Notes overleaf before fitting



Issue 3

TVAUX2VK VAUXHALL / OPEL ASTRA (K) HATCH 2015>

Item	Qty	Description	Item	Qty	Description
A	1	TVAUX2VK Crossmember	D	1	Flip Up Socket Plate (TTFP/LH)
B	2	Handed Side Arms	E	10	M10 x 35 (10.9) Bolts & S/P Washers
C	1	6201 Detachable Neck	F	6	M10 Nyloc Nuts
			G	2	M12 x 25 Bolts & S/P Washers
			H	2	M12 x 22 Bolts & S/P Washers
			J	16	10 x 25 Flat Washers
			K	4	12 x 25 Flat Washers
			L	2	Large Plastic Rivets

BUMPER REMOVAL:

1. Remove the rear light clusters, one fixing found inside boot area behind each cluster.
2. Remove the rear bumper, four fixings found around each wheel arch, one tip fixing each side, two fixings on the lower edge and two fixings behind the number plate.
3. Release bumper tips from the vehicles bodywork, unclip any necessary wiring looms and pull bumper rearward to remove.
4. Remove the rear impact beam, three fixings either side (This is NOT refitted with the Towbar assembly).

TOWBAR INSTALLATION:

1. Insert Items B into each correct chassis member and loosely fix in place using Item E with Item J.
2. Fit Item A onto the rear panel studs fixing in place using Item F with Item J.
3. Using Item E with Item J fix Items B to Item A.
4. Using Item E with Item J fix Item A to the lower face of each chassis member.
5. Using Item G with Item K and Item H with item K fix Item C and Item D to Item A.
6. Fully tighten all fixings ensuring the Towbar is rigid, square and secure.
7. Cut the rear bumper as per the sketch below and refit using Item L for the fixings behind the number plate.

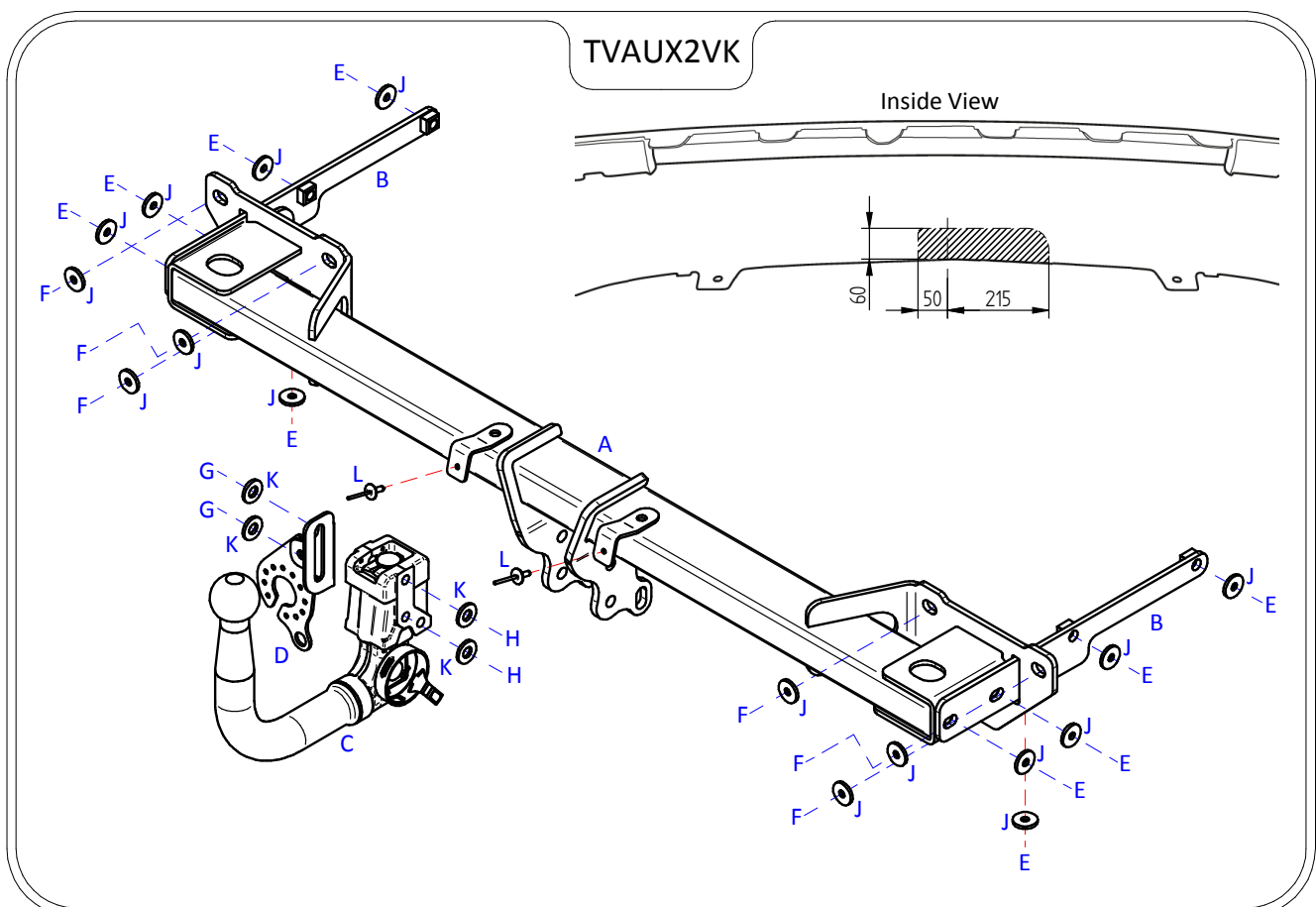

Note:

1. Recommended Torque Setting for M12 Grade 10.9 -139 Nm. (For other Torque Settings see notes overleaf.)
2. Nose load limits and vehicle manufacturers trailer / caravan weight limits must be observed.